

Mini - Dice Tower by Blue Panther Assembly



Mini Dice Tower by Blue Panther is
© 2008 by Blue Panther LLC
All rights reserved.



Blue Panther recommends white or yellow wood glue with at least 10 minute "open time"

1. Lay out all the components



2. Assemble interior ledges to slots in side of the tower first (no glue)

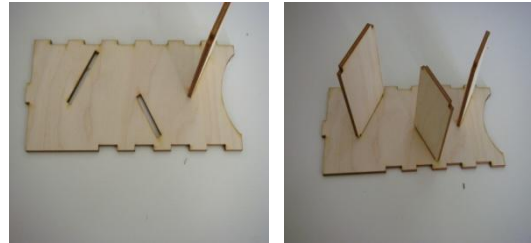

Mini Dice Tower, Birch, Unassembled
Mini Dice Tower, Wood Finish, Unassembled
MiniDice Tower, Stone Finish, Unassembled

3. Assemble other side.

Put glue in **all notches on all sides shown**. Use a rubber band to hold together then...

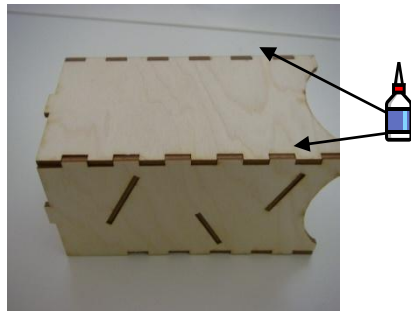
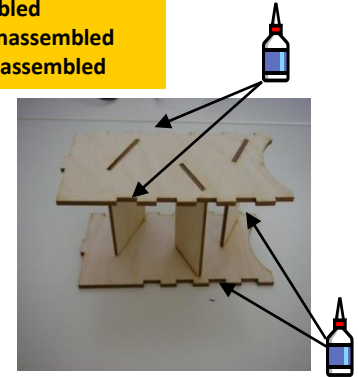

4. Put glue in **all notches on both sides of long wall**. Flip tower on its side assemble long wall to tower.

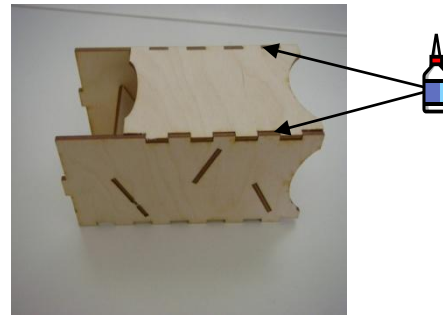

5. Flip tower over, put glue in **all notches** on both sides of short side and assemble to tower.

Base

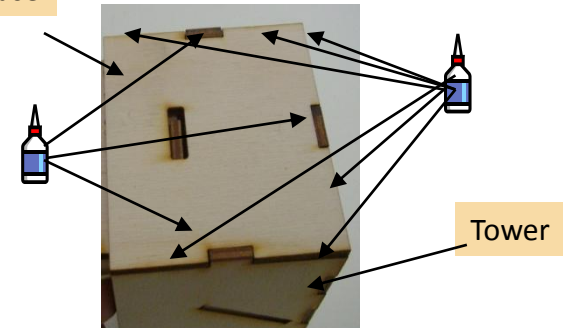

6. Stand tower upside-down. Put glue in all notches on bottom of tower and in notches on base. Assemble base to tower. Watch the glue dry. 😊



7. Place front of dice drawer face down

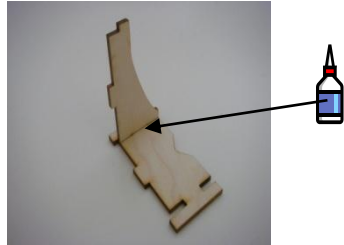

8. Glue notch in drawer side (not visible) and assemble to drawer front.

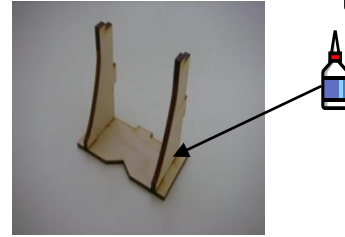

9. Glue and assemble the other drawer side the same way.

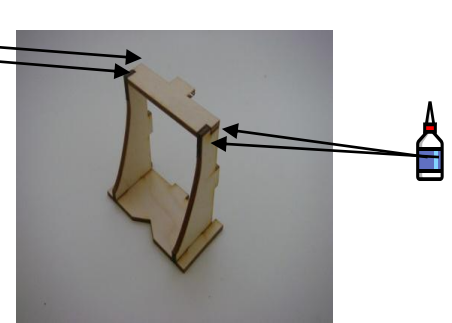

10. Glue notches on drawer sides **and** drawer back. Assemble drawer back to drawer sides. Secure with a rubber band.

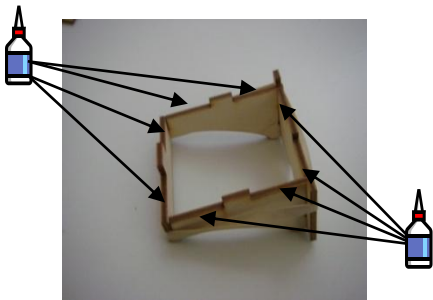

11. Place drawer upside down and apply glue to all notches.

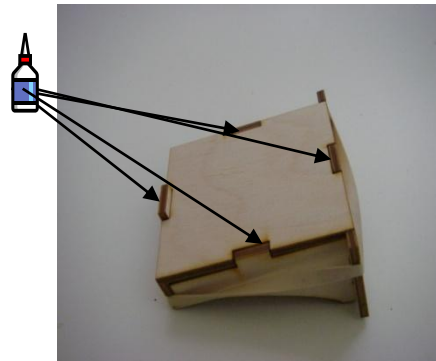

12. Apply glue to notches in drawer bottom and assemble to drawer.



13. Assemble drawer to tower & roll the dice!



© 2008 by Blue Panther LLC
All rights reserved.
www.bluepantherllc.com

Check out our whole line of dice towers and board games at www.bluepantherllc.com!